

SUSSEX Bottle Trap

SUSSEX

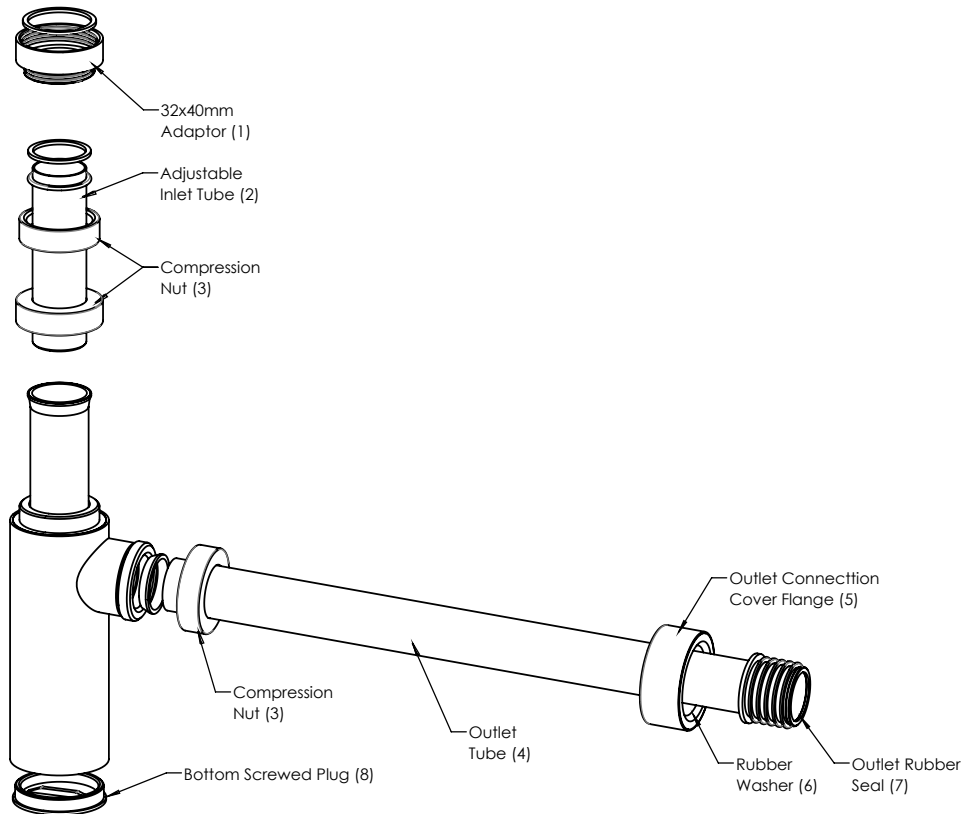

Product code

SXBT

Install:

1. 32x40mm Adaptor
2. Adjustable Inlet Tube
3. Compression Nut
4. Outlet Tube
5. Outlet Connection Cover Flange
6. Rubber Washer
7. Outlet Rubber Seal
8. Bottom Screwed Plug

Install:

The Bottle Trap can be connected to a 32 or 40mm plug & waste with the use of the 32 x 40mm Adaptor (1) included.

The outlet connection of the Bottle Trap is designed to connect to 40mm DWV pipe.

1. Apply a lubricant (O-ring lubricant or similar) to the 40mm DVW pipe and the rubber washer (6) inside Outlet Connection Cover Flange (5) to achieve an easy fit.
2. Cut the 40mm DWV pipe to ensure 0-10mm of pipe is protruding from the finished wall or back of the vanity cabinet. The pipe should be cut square and chamfered/deburred.
3. To measure the length of the Outlet Tube (4) to be cut. Attach the Bottle Trap to the P/W and insert the Outlet Tube (4) into the 40mm DVW pipe. Mark the point of entry. Remove the Outlet Pipe (4) and add 30mm for the Rubber Seal (7).
4. Push the Outlet Connection Cover Flange (5) assembly onto the Outlet Tube (4). Next push on the Rubber Seal (7). Lubricate the Rubber Seal (7).
5. Push the Outlet Tube (4) into the 40mm DVW pipe until the shoulder of the Rubber Seal (7) is against the pipe. Slide the Outlet Connection Cover Flange (4) over the 40mm DVW pipe until it is flush against the wall.
6. Connect the upstream end of the outlet tube to the Bottle Trap and then reconnect the Bottle Trap to the Plug and Waste.
7. Use the adjustable inlet tube (2) to set the height of the Bottle Trap to achieve sufficient fall in the outlet tube.
8. Ensure the bottom screwed plug (8) is tight.
9. Tighten all compression nuts (3) and water test to ensure there are no leaks.

